



TREE



SHRUBS



Sbc



Cyr



GROUNDCOVERS



Lsd

PLANT SCHEDULE

Code	Latin Name (Common Name - Mature Height)	Qty	Size	Stake
Trees				
G	Glochidion ferdinandi (Cheese Tree - 10m)	1	75 litre	yes
Shrubs				
Bx	Buxus microphylla 'Japonica' (Box 8 1m)	11	15 litre	-
Sbc	Syzygium 'Bush Christmas' (Lilly Pilly - 2m)	8	15 litre	-
Cyr	Cycas Revoluta (Cycas - 1.5m)	1	15 litre	-
Groundcovers				
Dlj	Dianella 'Little jess' (Dianella - 0.4m)	20	150 mm	-
Lsd	Liriope 'Silver Dragon' (Variegated Liriope - 0.3m)	30	150 mm	-

LEGEND

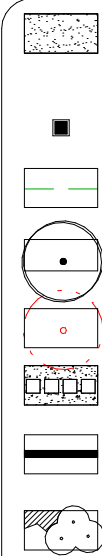

Turf
Excavate / grade all areas to be turfed to 120mm below required finished levels. Do not excavate within 1500mm of the trunk of any existing tree to be retained. Ensure that all surface water runoff is directed towards the inlet pits, kerbs etc., and away from buildings. Ensure that no pooling or ponding will occur. Rip the subgrade to 150mm. small gaps with topsoil. Water thoroughly.

Integrated wall / Individual bollard lighting
All external lighting around the premises is to be directed and shaded such that direct night light does not affect the amenity of adjoining and nearby residences. Any ancillary light fittings to the exterior of the building are to be properly installed

Brick garden edging
Lay a single course of paving bricks in a mortar haunch (200mm wide and 100mm deep). The edges are to be laid in even curves and straight line as shown on the plan. Where tight curves are shown use half bricks to show a more even curve. The top of the edge is to finish flush with the adjacent turf and mulch levels.

Existing trees to be retained

Existing trees to be removed

Precast concrete stepping stones in decorative gravel mulch

Planter box on top of concrete slab (Refer to detail)

Planting areas
Ensure that the mass planting areas have been excavated to 300 below finished levels. Rip to a further depth of 150mm. Supply and install 300mm soil mix. Soil mix to comprise of one part approved compost to three parts topsoil. Topsoil shall be either imported topsoil or stockpiled site topsoil (if suitable ie: No clay) Install 75mm depth of selected mulch.
Note:
Maintenance:
All landscape works are to be maintained for a period of three months from the date to achieve vigorous growth. Any defects which arise during this period are to be rectified immediately. Any plants or areas of turf which fail during this period are to be replaced at no additional cost.
Irrigation:
All areas on the landscape plan are to use and utilise the water tank system provided. All pipework is to be PVC to satisfy AS 1477. All installation is to satisfy the Sydney Water Code and AS 3500. The tank system is to be installed by a suitable licenced contractor. All equipment and workmanship is to be guaranteed for a minimum period of 12 months.
Fencing:
For all fencing types and materials refer to the Architects plans.

GENERAL NOTES

REFER TO HYDRAULIC / STRUCTURAL DESIGN DRAWINGS FOR ALL HYDRAULIC / STRUCTURAL DESIGN ELEMENTS
ALL BUILDING WORK MUST BE CARRIED OUT IN ACCORDANCE WITH THE PROVISIONS OF THE BUILDING CODE OF AUSTRALIA
ALL APPROVED CONSTRUCTION INCLUDING BUT NOT LIMITED TO FOOTINGS, WALLS, ROOF BARGES AND GUTTERINGS ARE TO BE CONSTRUCTED WHOLLY WITHIN THE BOUNDARIES OF THE PREMISES

 DIAL 1100 BEFORE YOU DIG
NO SUBSURFACE INVESTIGATION HAS BEEN MADE
IT IS YOUR RESPONSIBILITY TO OBTAIN SERVICE DIAGRAMS FROM RELEVANT AUTHORITIES

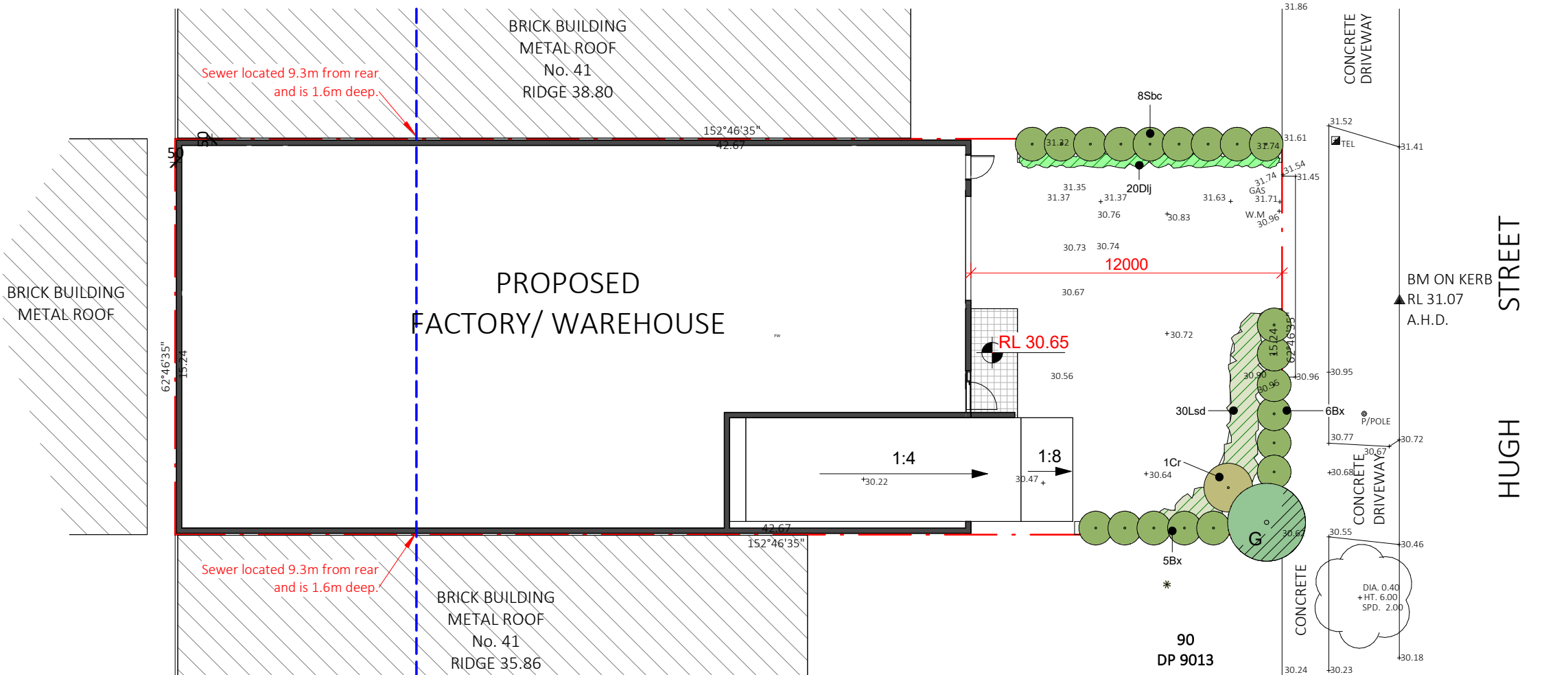

Sewer located 9.3m from rear and is 1.6m deep.

Sewer located 9.3m from rear and is 1.6m deep.

NOTE:
Retain constant fall to brick-on-flat

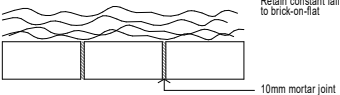

PLAN

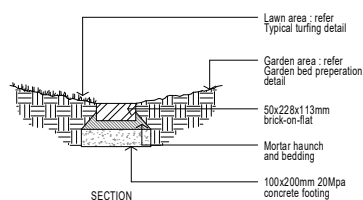

Brick garden edge Detail.

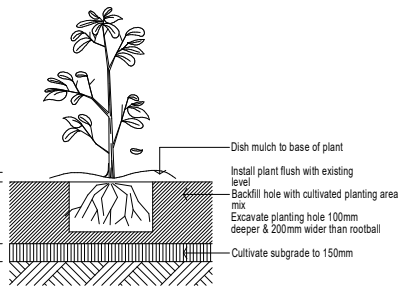

Planting in garden beds Detail.

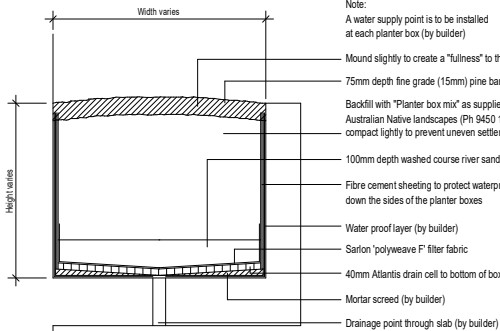

Typical planter box Detail.

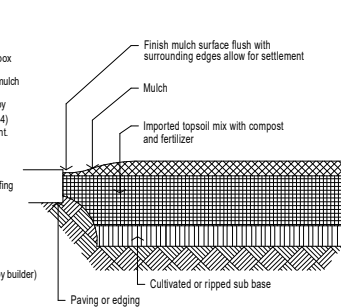

Ground preparation Planting area using imported topsoil Detail.

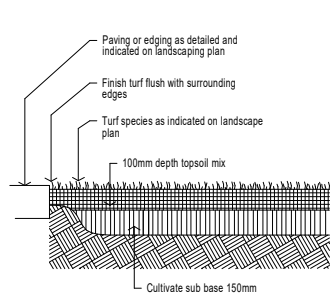

Ground preparation Grassed area: turf using imported topsoil Detail.

CK design
design + interiors

LEVEL 2, 240 CHURCH ST,
PARRAMATTA NSW 2150
P: 1300 253 000
M: 0466 787 141
M: 0411 222 888
E: chris@ckdesign.net.au
W: www.ckdesign.net.au

Member
Australian Institute
of Architects
Nominated Architect:
Joseph Panetta
NSW Architects Registration
Board No: 9505

No.	Description	Date

LANDSCAPE PLAN

PRELIMINARY NOT FOR
CONSTRUCTION

DEVELOPMENT APPLICATION
INDUSTRIAL DEVELOPMENT

CLIENT: PALMS PACIFIC
ADDRESS: 39 HUGH STREET, BELMORE

Scale	A3:As indicated
Date	MAY 24
Drawn by	Author
Checked by	Checker
Project number	24018-01
Sheet number	A3-15